



# ELECTRIC CHAIN HOIST

DMK SERIES



# TECHNICAL SPECIFICATIONS AND DATA FOR DMK CHAIN HOISTS WITH DMT TROLLEYS

## CHARACTERISTIC DATA FOR DMK SERIES ELECTRIC CHAIN HOISTS AND DMT TROLLEYS

CAPACITY (kg)	FEM GROUP	DMK TYPE	CHAIN FALLS	LIFTING SPEED (m/min)		LIFTING MOTOR POWER (kW)		DMT TROLLEY TYPE FOR HOIST						TROLLEY MOTOR POWER (kW)				CHAIN TYPE	CHAIN WEIGHT PER METER (kg/m)
								S= MANUAL-PUSH TROLLEY C= MANUAL GEAR OPERATED TROLLEY E=ELECTRIC TROLLEY		SPEED (m/min)				SPEED (m/min)					
				1 SPE.	2 SPE.	1 SPE.	2 SPE.	S	C	E SPEED (m/min)				SPEED (m/min)					
								11	14	22	7/22	11	14	22	7/22				
125	2m	154C	1	8	/	0.2	/	SM2	CM3	EM3	EM3	EM3	EM3	0.12	0.18	0.25	0.08 0.25	4x12	0.38
	2m	132D	1	8	2.5	0.2	0.06	SM2	CM3	EM3	EM3	EM3	EM3	0.12	0.18	0.25	0.08 0.25	4x12	0.38
	2m	232C	1	16	/	0.4	/	SM2	CM3	EM3	EM3	EM3	EM3	0.12	0.18	0.25	0.08 0.25	5x15	0.58
250	2m	134C	1	4	/	0.2	/	SM2	CM3	EM3	EM3	EM3	EM3	0.12	0.18	0.25	0.08 0.25	4X12	0.38
	2m	112D	1	4	1.2	0.2	0.06	SM2	CM3	EM3	EM3	EM3	EM3	0.12	0.18	0.25	0.08 0.25	4X12	0.38
	2m	234C	1	8	/	0.4	/	SM2	CM3	EM3	EM3	EM3	EM3	0.12	0.18	0.25	0.08 0.25	5x15	0.58
	2m	234D	1	8	2.5	0.4	0.12	SM2	CM3	EM3	EM3	EM3	EM3	0.12	0.18	0.25	0.08 0.25	5x15	0.58
500	2m	332C	1	16	/	0.8	/	SM3	CM3	EM3	EM3	EM3	EM3	0.12	0.18	0.25	0.08 0.25	7x21	1.16
	2m	214C	1	4	/	0.4	/	SM2	CM3	EM3	EM3	EM3	EM3	0.12	0.18	0.25	0.08 0.25	5x15	0.58
	2m	214D	1	4	1.2	0.4	0.12	SM2	CM3	EM3	EM3	EM3	EM3	0.12	0.18	0.25	0.08 0.25	5x15	0.58
	2m	334C	1	8	/	0.8	/	SM3	CM3	EM3	EM3	EM3	EM3	0.12	0.18	0.25	0.08 0.25	7x21	1.16
	2m	334D	1	8	2.5	0.8	0.24	SM3	CM3	EM3	EM3	EM3	EM3	0.12	0.18	0.25	0.08 0.25	7x21	1.16
1000	2m	432C	1	16	/	1.6	/	SM4	CM4	EM4	EM4	EM4	EM4	0.12	0.18	0.25	0.08 0.25	10x28	2.42
	2m	314C	1	4	/	0.8	/	SM3	CM3	EM3	EM3	EM3	EM3	0.12	0.18	0.25	0.08 0.25	7x21	1.16
	2m	314D	1	4	1.2	0.8	0.24	SM3	CM3	EM3	EM3	EM3	EM3	0.12	0.18	0.25	0.08 0.25	7x21	1.16
	2m	434C	1	8	/	1.6	/	SM4	CM4	EM4	EM4	EM4	EM4	0.12	0.18	0.25	0.08 0.25	10x28	2.42
1600	2m	434D	1	8	2.5	1.6	0.5	SM4	CM4	EM4	EM4	EM4	EM4	0.12	0.18	0.25	0.08 0.25	10x28	2.42
	2m	424L	1	6.3	/	2.5	/	SM4	CM4	EM4	EM4	EM4	EM4	0.12	0.18	0.25	0.08 0.25	10x28	2.42
2000	2m	424D	1	6.3	2.1	2	0.65	SM4	CM4	EM4	EM4	EM4	EM4	0.12	0.18	0.25	0.08 0.25	10x28	2.42
	2m	414C	1	4	/	1.6	/	SM4	CM4	EM4	EM4	EM4	EM4	0.12	0.18	0.25	0.08 0.25	10x28	2.42
2500	2m	414D	1	4	1.2	1.6	0.5	SM4	CM4	EM4	EM4	EM4	EM4	0.12	0.18	0.25	0.08 0.25	10x28	2.42
	2m	434L.I	2	4	/	2.5	/	SM5	CM5	EM5	EM5	EM5	EM5	0.17	0.25	0.37	0.08 0.25	10x28	2.42
3200	2m	424D.I	2	3.2	1	2	0.65	SM5	CM5	EM5	EM5	EM5	EM5	0.17	0.25	0.37	0.08 0.25	10x28	2.42
	1Am	434L.J	2	4	/	2.5	/	SM5	CM5	EM5	EM5	EM5	EM5	0.17	0.25	0.37	0.08 0.25	10x28	2.42
	1Am	424D.J	2	3.2	1	2	0.65	SM5	CM5	EM5	EM5	EM5	EM5	0.17	0.25	0.37	0.08 0.25	10x28	2.42
	2m	424L.J	2	3.2	/	2.5	/	SM5	CM5	EM5	EM5	EM5	EM5	0.17	0.25	0.37	0.08 0.25	10x28	2.42
4000	2m	454D.J	2	2.5	0.8	2	0.65	SM5	CM5	EM5	EM5	EM5	EM5	0.17	0.25	0.37	0.08 0.25	10x28	2.42
	1Am	424L.K	2	3.2	/	2.5	/	SM5	CM5	EM5	EM5	EM5	EM5	0.17	0.25	0.37	0.08 0.25	10x28	2.42
	1Am	454D.K	2	2.5	0.8	2	0.65	SM5	CM5	EM5	EM5	EM5	EM5	0.17	0.25	0.37	0.08 0.25	10x28	2.42

## SINGLE-PHASE VERSION

CAPACITY (kg)	FEM GROUP	DMK TYPE	CHAIN FALLS	LIFTING SPEED (m/min)		LIFTING MOTOR POWER (kW)		DMT TROLLEY TYPE FOR HOIST				CHAIN TYPE	CHAIN WEIGHT PER METER (kg/m)
				1 SPE.	2 SPE.	1 SPE.	2 SPE.	S		C			
100	1Bm	132M	1	8	/	0.2	/	SM2		CM3		4x12	0.38
200	1Bm	112M	1	4	/	0.2	/	SM2		CM3		4x12	0.38
	1Bm	234M	1	8	/	0.4	/	SM2		CM3		5x15	0.58
400	1Bm	214M	1	4	/	0.4	/	SM2		CM3		5x15	0.58
	1Bm	334M	1	8	/	0.8	/	SM3		CM3		7x21	1.16
800	1Bm	314M	1	4	/	0.8	/	SM3		CM3		7x21	1.16

**DMK ELECTRIC CHAIN HOISTS – OVERALL DIMENSIONS WEIGHTS – FIXED EXECUTION**

1 chain fall version

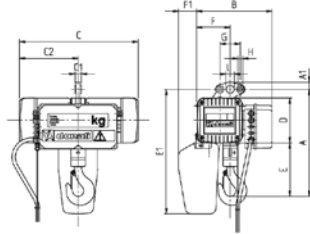

2 chain falls version

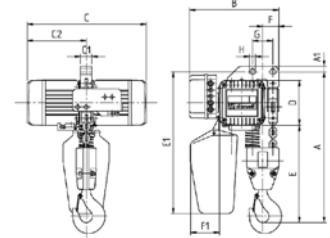

SIZE	CHAIN FALLS	DMK TYPE	*HOIST WEIGHT (kg)	OVERALL DIMENSIONS (mm)											
				**A	A1	B	C	C1	C2	D	**E	F	G	H	I
1	1	154C	23	275	23	253	385	19	207	120	128	80	70	14	27
	1	132D/M	23	275	23	253	385	19	207	120	128	80	70	14	27
	1	134C	23	275	23	253	385	19	207	120	128	80	70	14	27
	1	112D/M	23	275	23	253	385	19	207	120	128	80	70	14	27
2	1	232C	33	310	23	268	438	19	237	135	150	92	70	14	27
	1	234C/M	33	310	23	268	438	19	237	135	150	92	70	14	27
	1	234D	33	310	23	268	438	19	237	135	150	92	70	14	27
	1	214C/M	33	310	23	268	438	19	237	135	150	92	70	14	27
	1	214D	33	310	23	268	438	19	237	135	150	92	70	14	27
3	1	332C	50	378	28	293	514	25	274	160	188	114	70	14	30
	1	334C/M	50	378	28	293	514	25	274	160	188	114	70	14	30
	1	334D	50	378	28	293	514	25	274	160	188	114	70	14	30
	1	314C/M	50	378	28	293	514	25	274	160	188	114	70	14	30
	1	314D	50	378	28	293	514	25	274	160	188	114	70	14	30
4	1	432C	80	471	32	332	583	27	317	200	233	146	90	20	35
	1	434C	80	471	32	332	583	27	317	200	233	146	90	20	35
	1	434D	80	471	32	332	583	27	317	200	233	146	90	20	35
	1	424L	80	471	32	332	583	27	317	200	233	146	90	20	35
	1	414C	80	471	32	332	583	27	317	200	233	146	90	20	35
	1	414D	80	471	32	332	583	27	317	200	233	146	90	20	35
	2	434L.I	105	670	25	395	583	50	317	200	432	71	90	25	/
	2	424D.I	105	670	25	395	583	50	317	200	432	71	90	25	/
	2	434L.J	105	670	25	395	583	50	317	200	432	71	90	25	/
	2	424D.J	105	670	25	395	583	50	317	200	432	71	90	25	/
	2	424L.J	105	670	25	395	583	50	317	200	432	71	90	25	/
	2	454D.J	105	670	25	395	583	50	317	200	432	71	90	25	/
	2	424L.K	105	670	25	395	583	50	317	200	432	71	90	25	/
	2	454D.K	105	670	25	395	583	50	317	200	432	71	90	25	/

\* Weight of hoist with 3m hook run and 2m push button panel cable

\*\* With application of raise/lower electric limit switches A and E dimensions increase by: DMK1 + 45mm; DMK2 + 40mm; DMK3 + 45mm; DMK4 (1 fall) + 60mm

**CHAIN BOX TYPE (C-D-E-F-G-H-I)**

SIZE	CHAIN FALLS		C	D	E	F	G	H	I
1	1	Max hook run (m)	5	8	13	20	32	70	115
	1	E1	347	372	397	427	467	522	607
	1	F1	47	63	77	100	120	150	200
2	1	Max hook run (m)	/	4	7	12	18	30	70
	1	E1	/	385	410	440	480	535	620
	1	F1	/	56	70	92	112	142	192
3	1	Max hook run (m)	/	/	3	5	9	16	25
	1	E1	/	/	440	470	510	560	650
	1	F1	/	/	55	77	97	127	177
4	1	Max hook run (m)	/	/	/	/	4	8	13
	1	E1	/	/	/	/	560	610	700
	1	F1	/	/	/	/	80	110	160
	2	Max hook run (m)	/	/	/	/	/	3	5
	2	E1	/	/	/	/	/	628	718
	2	F1	/	/	/	/	/	130	180

NOTE With application of raise/lower limit switches on 1 chain fall hoists, the maximum capacity of the chain box decreases by 1 m of hook run and the E1 dimension increases by 25 mm.

# DMK ELECTRIC CHAIN HOISTS WITH DMT TROLLEYS

## OVERALL DIMENSIONS – WEIGHTS

Hoist with SM hand-push trolley

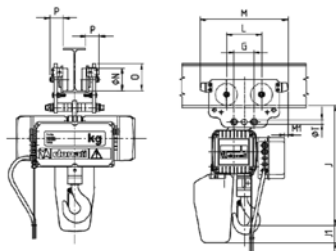

Hoist with EM electric trolley

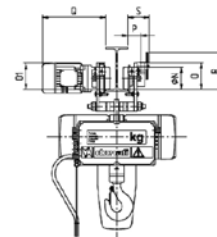

Hoist with CM manual gear operated trolley

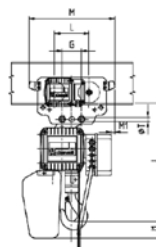
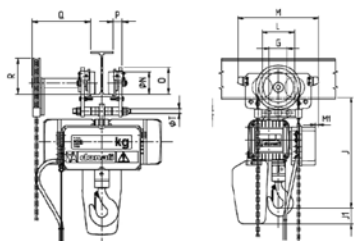

1 chain fall version

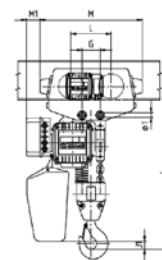

2 chain falls version

DMK SIZE	CHAIN FALLS	DMT TROLLEY TYPE	*HOIST TROLLEY WEIGHT (kg)	OVERALL DIMENSIONS (mm)											
				***J	L	M	M1	Ø N	O	**O1	P	**Q	R	S	Ø T
1	1	SM2	29	323	100	236	54	52	72	/	20	/	/	/	M16
	1	EM3	58	345	135	362	-10	80	98	100(108)	54	290(314)	165	90	M14
	1	CM3	41	345	135	362	-10	80	98	/	54	240	108	/	M14
2	1	SM2	39	360	100	236	58	52	72	/	20	/	/	/	M16
	1	EM3	68	380	135	362	-6	80	98	100(108)	54	290(314)	165	90	M14
	1	CM3	51	380	135	362	-6	80	98	/	54	240	108	/	M14
3	1	SM3	62	448	135	362	-3	80	98	/	54	/	/	/	M14
	1	EM3	85	448	135	362	-3	80	98	100(108)	54	290(314)	165	90	M14
	1	CM3	68	448	135	362	-3	80	98	/	54	240	108	/	M14
4	1	SM4	105	547	160	402	-15	100	120	/	60	/	/	/	M20
	1	EM4	130	547	160	402	-15	100	120	110/(118)	60	296(320)	165	96	M20
	1	CM4	115	547	165	402	-15	100	120	/	60	264	160	/	M20
	2	SM5	160	755	201	510	70	125	155	/	55	/	/	/	M24
	2	EM5	190	755	201	510	70	125	155	130(130)	55	316(316)	211	110	M24
	2	CM5	170	755	201	510	70	125	155	/	55	350	198	/	M24

\* Weight referred to 3m hook-run hoist.

\*\* Dimensions for 2 speed trolleys in brackets.

\*\*\* SM3/EM3/CM3: for width > 220 mm up to 400 mm dimension J increases by 70 mm

\*\*\* SM4/EM4/CM4: for width > 220 mm up to 400 mm dimension J increases by 60 mm

\*\*\* SM5/EM5/CM5: for width > 220 mm up to 400 mm dimension J increases by 75 mm

Note When the hoist is equipped with raise/lower limit switches, dimension J increases as much as dimensions A and E, page 11 and note regarding the chain box

## MAXIMUM REACTIONS OF DMT TROLLEY WHEELS ON BEAM FLANGE

DMK SIZE	MAX CAPACITY (kg)	DMT TROLLEY TYPE	OVERALL DIMENSIONS (mm)				
			Ø R	I	B	*R MAX (kg)	SP MAX
1	250	SM2	52	5	15	80	17
		EM3/CM3	80	7	16	87	22
2	500	SM2	52	5	15	154	17
		EM3/CM3	80	7	16	161	22
3	1000	SM3					
		EM3/CM3	80	7	16	309	22
4	2000	SM4					
		EM4/CM4	100	9	19	608	24
	4000	SM5					
		EM5/CM5	125	14	29	1193	20

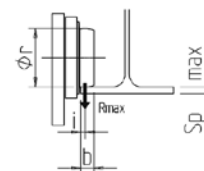

\* Max R calculated with a dynamic coefficient of 1.15 and no "M" increasing coefficient

# DMK ELECTRIC CHAIN HOISTS LOW HEAD ROOM EXECUTION

## OVERALL DIMENSIONS – WEIGHTS

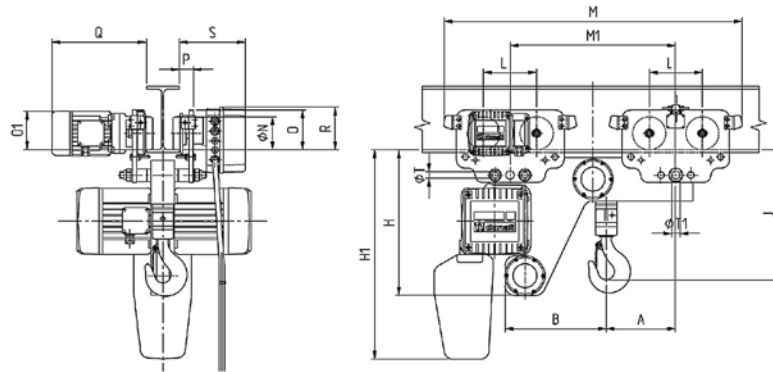

DMK SIZE	MAX CAPACITY (kg)	DMT TROLLEY TYPE	*HOIST TROLLEY WEIGHT (kg)	OVERALL DIMENSIONS (mm)																
				A	B	H	***H1	J	L	M	M1	Ø N	O	**O1	P	**Q	R	S	Ø T	Ø T1
1	250	SM3+SM3	60	170	228	317	417	233	135	742	380	80	98	/	54	/	108	/	M14	M16
		SM3+EM3	75	170	228	317	417	233	135	742	380	80	98	100/(108)	54	290/(314)	108	196	M14	M16
2	500	SM3+SM3	67	176	240	346	455	255	135	762	386	80	98	/	54	/	108	/	M14	M16
		SM3+EM3	80	176	240	346	455	255	135	762	386	80	98	100/(108)	54	290/(314)	108	196	M14	M16
3	1000	SM3+SM3	100	190	275	390	510	313	135	812	450	80	98	/	54	/	108	/	M14	M16
		SM3+EM3	115	190	275	390	510	313	135	812	450	80	98	100/(108)	54	290/(314)	108	196	M14	M16
4	2000	SM4+SM4	155	205	310	462	637	386	160	902	500	100	120	/	60	/	118	/	M20	M24
		SM4+EM4	170	205	310	462	637	386	160	902	500	100	120	110/(118)	60	296/(320)	118	202	M20	M24
	4000	UPON REQUEST	/	/	/	/	/	/	/	/	/	/	/	/	/	/	/	/	/	/
		UPON REQUEST	/	/	/	/	/	/	/	/	/	/	/	/	/	/	/	/	/	/

\* Weight referred to 3m hook-run hoist.  
 \*\* Dimensions for 2 speed trolleys in brackets  
 \*\*\* Weight referred to 3m hook-run hoist

With application of an electric raise/lower limit switch dimension H1 increases by 25mm and dimension J increases by: DMK1+45mm; DMK2+40mm; DMK3+45mm; DMK4(1 fall)+60mm

## MAXIMUM REACTIONS OF DMT TROLLEY WHEELS ON BEAM FLANGE FOR DMK LOW HEAD ROOM EXECUTION

DMK SIZE	MAX CAPACITY (kg)	DMT TROLLEY TYPE	OVERALL DIMENSIONS (mm)					*R MAX (kg)	SP MAX
			Ø R	I	B				
1	250	SM3+SM3	80	7	16	44		18	
		SM3+EM3				87			
2	500	SM3+SM3	80	7	16	80		18	
		SM3+EM3				82			
3	1000	SM3+SM3	80	7	16	156		18	
		SM3+EM3				158			
4	2000	SM4+SM4	100	9	19	307		21	
		SM4+EM4				608			
	4000	SM5+EM5 (UPON REQUEST)	125	14	29	/		/	
		SM5+EM5 (UPON REQUEST)				/			

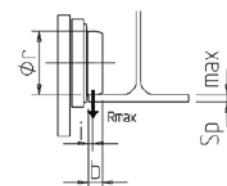

\* Max R calculated with a dynamic coefficient of 1.15 and no "M" increasing coefficient

**TECHNICAL SPECIFICATIONS AND DATA FOR DMK HOIST CHAIN CLIMBING EXECUTION**

CAPACITY (kg)	FEM GROUP	DMK TYPE	CHAIN FALLS	LIFTING SPEED (mm)		LIFTING MOTOR POWER (kW)		*HOIST WEIGHT (kg)	CHAIN TYPE	CHAIN WEIGHT PER METER (kg/m)
				1 SPEED	2 SPEED	1 SPEED	2 SPEED			
125	2m	154C	1	8	/	0.2	/	17	4x12	0.38
250	2m	134C	1	4	/	0.2	/	17	4x12	0.38
	2m	234C	1	8	/	0.4	/	24	5x15	0.58
500	2m	214C	1	4	/	0.4	/	24	5x15	0.58
	2m	334C	1	8	/	0.8	/	38	7x21	1.16
1000	2m	314C	1	4	/	0.8	/	38	7x21	1.16
	2m	434C	1	8	/	1.6	/	65	10x28	2.42
2000	2m	414C	1	4	/	1.6	/	65	10x28	2.42

\* Hoist weight without chain

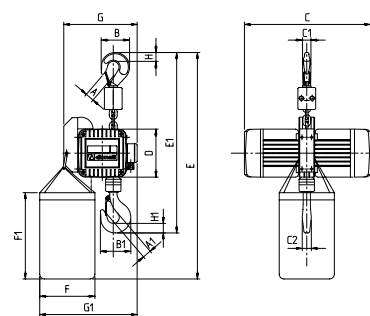

**CLIMBING VERSION**

**OVERALL DIMENSIONS - WEIGHTS**

DMK SIZE	MAX CAPACITY (kg)	DMK HOIST TYPE	OVERALL DIMENSIONS (mm)															
			A	A1	B	B1	C	C1	C2	D	E	E1	F	F1	G	G1	H	H1
1	125	154C	21	24	62	67	385	22	19	120	710	400	230	360	210	310	17	19
	250	134C	21	24	62	67	385	22	19	120	710	400	230	360	210	310	17	19
2	250	234C	25	28	78	83	438	22	23	135	740	465	230	360	225	325	22	24
	500	214C	25	28	78	83	438	22	23	135	740	465	230	360	225	325	22	24
3	500	334C	30	34	96	103	514	27	30	160	800	577	230	360	250	350	29	32
	1000	314C	30	34	96	103	514	27	30	160	800	577	230	360	250	350	29	32
4	1000	434C	36	40	118	137	583	35	38	200	880	716	230	360	307	410	37	44
	2000	414C	36	40	118	137	583	35	38	200	880	716	230	360	307	410	37	44

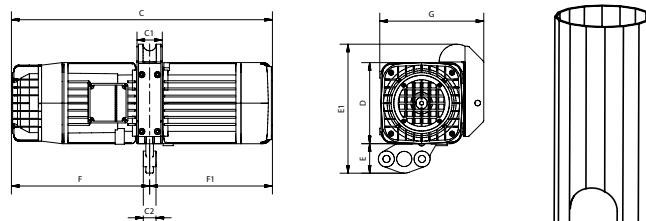

**TOWER VERSION**

**OVERALL DIMENSIONS - WEIGHTS**

DMK SIZE	MAX CAPACITY (kg)	DMK HOIST TYPE	OVERALL DIMENSIONS (mm)								
			C	C1	C2	D	E	E1	F	F1	G
1	125	154C	385	40	19	120	49	202	178	177	157
	250	134C	385	40	19	120	49	202	178	177	157
2	250	234C	438	44	19	135	48	217	201	237	172
	500	214C	438	44	19	135	48	217	201	237	172
3	500	334C	514	50	25	160	58	252	240	274	197
	1000	314C	514	50	25	160	58	252	240	274	197
4	1000	434C	583	65	27	200	70	319	266	347	255
	2000	414C	583	65	27	200	70	319	266	347	255

Suitable for incorporation into metal poles used for lighting. For assembly and maintenance, relevant chain return allows a mobile crown, fitted with lights, to be lifted and lowered along the pole itself. In order to guarantee excellent operation, the hoist is assembled in an inverted position with respect to standard applications.

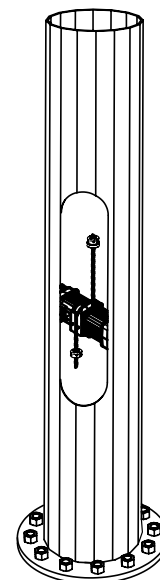

# SPECIFICATIONS OF MOTORS, FUSES AND POWER CABLES

TROLLEY TYPE	BEAM TYPE	GROUP 1		GROUP 2		GROUP 3		GROUP 4		*MINIMUM RADIUS OF MONORAIL INTERNAL CURVATURE (mm)
		BEAM	FLANGE	BEAM	FLANGE	BEAM	FLANGE	BEAM	FLANGE	
SM2	INP	80÷160	42÷74	180÷280	82÷119	300÷380	125÷149	400	155	1000
	IPE	80÷140	46÷73	160÷240	82÷120	270÷300	135÷150	330÷500	160÷200	
	HEA	-	-	100÷120	100÷120	140	140	160÷200	160÷200	
SM3	INP	120÷240	58÷106	260÷450	113÷170	475÷600	178÷215	-	-	1300
	IPE	120÷220	64÷110	240÷360	120÷170	400÷600	180÷220	-	-	
	HEA	-	-	140÷160	140÷160	180÷220	180÷220	-	-	
SM4	INP	160÷280	74÷119	300÷475	125÷178	500÷600	185÷215	-	-	1500
	IPE	160÷240	82÷120	270÷400	135÷180	450÷600	190÷220	-	-	
	HEA	-	-	160÷180	160÷180	200÷220	200÷220	-	-	
SM5	INP	180÷300	82÷125	320÷500	131÷185	550÷600	200÷215	-	-	1900
	IPE	180÷240	91÷120	270÷400	135÷180	450÷600	190÷220	-	-	
	HEA	-	-	180	180	200÷240	200÷240	-	-	
CM3	INP	140÷240	66÷106	260÷450	113÷170	475÷600	178÷215	-	-	1300
	IPE	140÷220	73÷110	240÷360	120÷170	400÷600	180÷220	-	-	
	HEA	-	-	140÷160	140÷160	180÷220	180÷220	-	-	
CM4	INP	180÷280	82÷119	300÷475	125÷178	500÷600	185÷215	-	-	1500
	IPE	180÷240	91÷120	270÷400	135÷180	450÷600	190÷220	-	-	
	HEA	-	-	160÷180	160÷180	200÷220	200÷220	-	-	
CM5	INP	220÷300	98÷125	320÷500	131÷185	550÷600	200÷215	-	-	1900
	IPE	220÷240	110÷120	270÷400	135÷180	450÷600	190÷220	-	-	
	HEA	-	-	180	180	200÷240	200÷240	-	-	
EM3	INP	120÷240	58÷106	260÷450	113÷170	475÷600	178÷215	-	-	1300
	IPE	120÷220	64÷110	240÷360	120÷170	400÷600	180÷220	-	-	
	HEA	-	-	140÷160	140÷160	180÷220	180÷220	-	-	
EM4	INP	160÷280	74÷119	300÷475	125÷178	500÷600	185÷215	-	-	1500
	IPE	160÷240	82÷120	270÷400	135÷180	450÷600	190÷220	-	-	
	HEA	-	-	160÷180	160÷180	200÷220	200÷220	-	-	
EM5	INP	180÷300	82÷125	320÷500	131÷185	550÷600	200÷215	-	-	1900
	IPE	180÷240	91÷120	270÷400	135÷180	450÷600	190÷220	-	-	
	HEA	-	-	180	180	200÷240	200÷240	-	-	

NOTE: For EM trolleys with electric travel limit switches, check the R dimensions on page 12

\* Electric trolleys suitable to run on a bend with guide roller kit

**SPECIFICATIONS OF MOTORS, FUSES AND POWER CABLES**

HOIST TYPE	MOTOR TYPE	POLES	POWER (kW)	POWER FACTOR COS $\phi$	I <sub>a</sub> 50Hz		(I <sub>n</sub> ) 50	FUSES aM	POWER CABLE SECTION 400V - ( $\Delta$ U20V)	
					380V A	400V A	415V A	400V A	$\Phi$ mm <sup>2</sup>	L =m
134C-154C	71C4AS1/1	4	0.2	0.43	3.8		(1.4)	4	1.5	≤ 100
112D-132D	72K1AS1/1	2/6	0.2/0.06	0.6/0.5	3.3/1.8		(0.8/0.8)	4	1.5	≤ 100
232C	80C2AS2/2	2	0.4	0.45	6.5		(2.5)	4	1.5	≤ 100
214C-234C	80C4AS2/2	4	0.4	0.48	6.4		(2.1)	4	1.5	≤ 100
214D-234D	81K5AS2/2	4/12	0.4/0.12	0.6/0.6	5.2/3		(1.6/2)	4	1.5	≤ 100
332C	90C2AS3/2	2	0.8	0.6	14.5		(4.8)	6	1.5	≤ 70
314C-334C	90C4AS3/2	4	0.8	0.46	14		(5.2)	6	1.5	≤ 70
314D-334D	91K5AS3/3	4/12	0.8/0.24	0.6/0.5	14.6/4		(3.1/2.6)	6	1.5	≤ 70
432C	100C2AS4/2	2	1.6	0.7	32		(6.2)	10	2.5	≤ 50
414C-434C	100C4AS4/2	4	1.6	0.6	28		(6.5)	10	2.5	≤ 60
424L-434L	101K4AS4/2	4	2.5	0.7	38		(6.2)	10	2.5	≤ 40
414D-434D	101K5AS4/2	4/12	1.6/0.5	0.62/0.4	28/12		(5.5/6)	10	2.5	≤ 60
424D-454D	101K5AS4/4	4/12	2/0.65	0.72/0.5	28/8		(6.5/5)	10	2.5	≤ 60

SINGLE-PHASE HOIST	MOTOR TYPE	POLES	POWER (kW)	POWER FACTOR COS $\phi$	I <sub>a</sub> 50Hz		(I <sub>n</sub> ) 50	FUSES aM	POWER CABLE SECTION 230V - ( $\Delta$ U20V)	
					230V A		230V A	$\Phi$ mm <sup>2</sup>	L =m	
132M-112M	72K2AM1/1	2	0.2	0.9	9.6		(3.2)	6	1.5	≤ 60
234M-214M	81K4AM2/1	4	0.4	0.9	11.3		(5.2)	10	1.5	≤ 50
334M-314M	91K4AM3/2	4	0.8	0.9	32		(12)	20	2.5	≤ 30

TROLLEY TYPE	MOTOR TYPE	POLES	POWER (kW)	POWER FACTOR COS $\phi$	I <sub>a</sub> - (A) 400V - 50HZ	I <sub>n</sub> - (A) 400V - 50HZ
EM3-EM4	71C4TV1/1	4	0.25	0.43	3.8	1.4
EM3-EM4	71C8TS1/1	8	0.12	0.53	2.5	1.3
EM3-EM4	72K6TS1/1	6	0.18	0.5	3	1.7
EM3-EM4-EM5	81C5AD2/1	4/12	0.25/0.08	0.54/0.7	4.5/1.8	1.4/1.2
EM5	80C4TV2/1	4	0.37	0.7	4.4	1.7
EM5	80C8TS2/1	8	0.17	0.5	2.6	1.6
EM5	80C6TS2/1	6	0.25	0.5	3.8	1.2